

i

SIDE BY SIDE

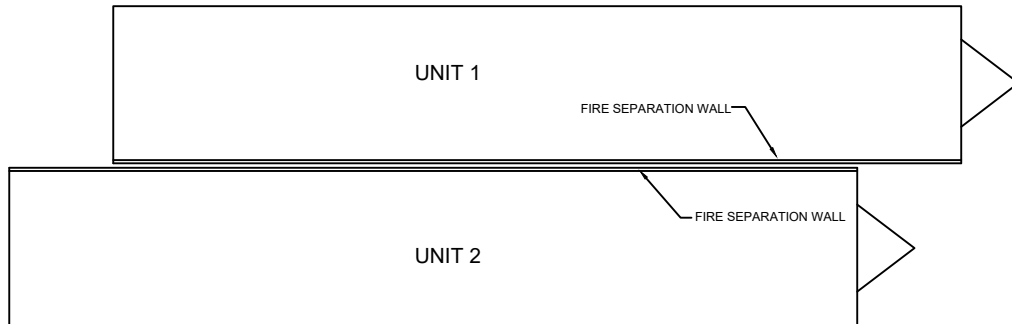

ii

SIDE BY SIDE; OFFSET

Notes:

1. Each attached manufactured home is independent and must meet all standards set forth in 24CFR part 3280; Manufactured Home Construction and Safety Standards.
2. Other configurations or combinations may apply. See DAPIA approved floor plans.
3. Fire separation walls must not contain through penetrations or openings.
4. Listed 2-hour fire-resistant nonmetallic electrical boxes that are installed in accordance with the listing are allowed in the fire separation wall on the conditioned side.
5. Each manufactured home must have an individual water supply that will service only that unit.
6. Each manufactured home must have a hot water supply system that will service only that unit.
7. Each attached manufactured home must be supplied by only one electrical service.
8. Service conductors supplying one manufactured home must not pass through the interior of another manufactured home.
9. Each attached manufactured home must have an individual drain, waste, and vent system that will serve only that unit.
10. Each attached manufactured home with gas service must have an individual supply that will serve only that unit.
11. Each attached manufactured home must have heating equipment meeting the requirements of 3280.506 that will serve only that unit.



PROPRIETARY AND CONFIDENTIAL
 These drawings and specifications are original, proprietary, confidential materials of Fleetwood Homes, Inc.
 Copyright 2019 Fleetwood Homes, Inc.

FLEETWOOD HOMES, INC.

TITLE
 ATTACHED MANUFACTURED HOMES

Calculation Numbers

By: DO	NO.	REV.
Date: 09/08/23	60-60-0001.01	

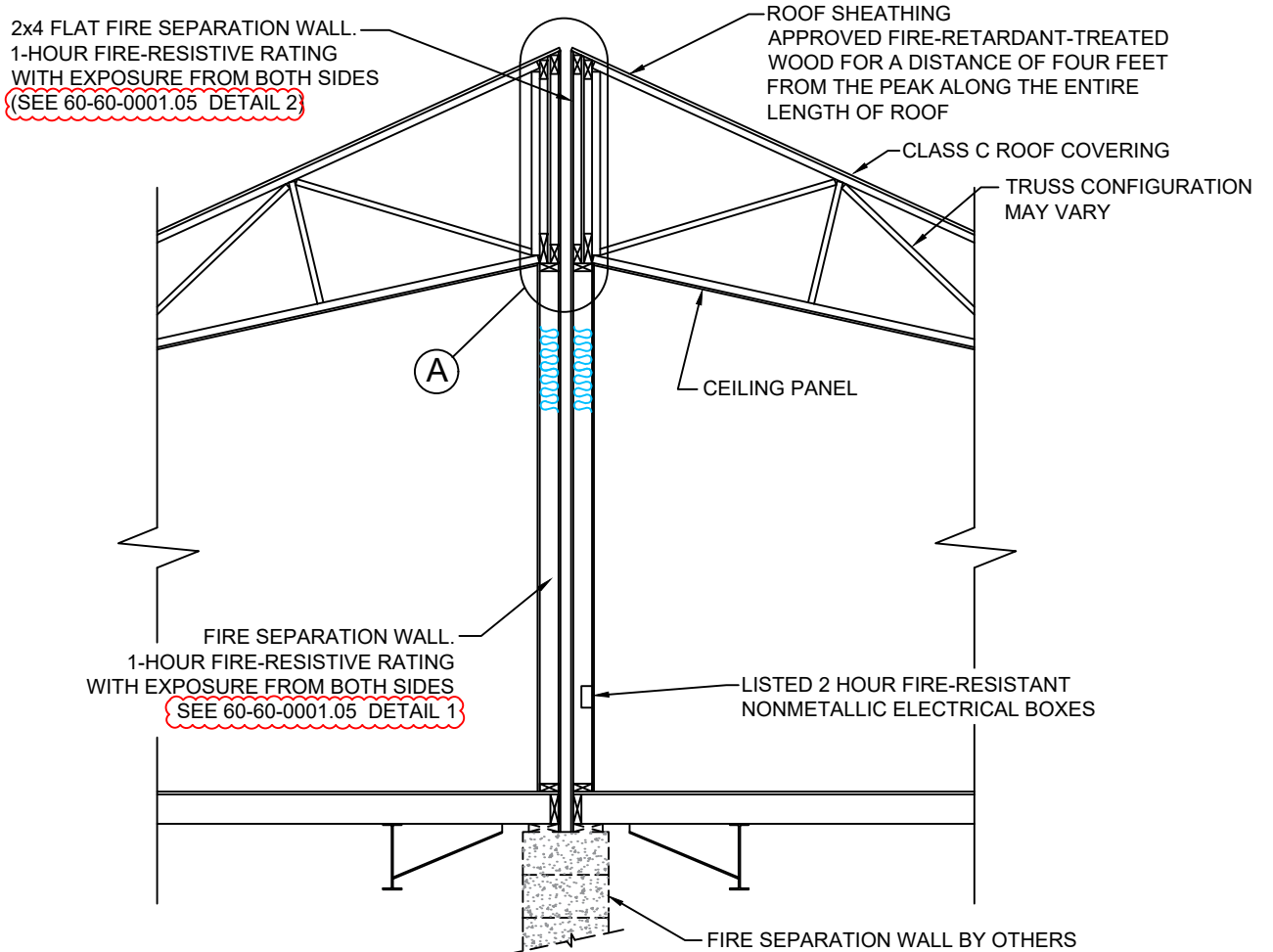

i

FIRE SEPARATION WALLS

PROPRIETARY AND CONFIDENTIAL
 These drawings and specifications are original, proprietary, confidential materials of Fleetwood Homes, Inc.
 Copyright 2019 Fleetwood Homes, Inc.

FLEETWOOD HOMES, INC.

TITLE
 ATTACHED MANUFACTURED HOMES
 SIDE BY SIDE UNITS

Calculation Numbers		

By: DO	NO.	REV.
Date: 10/27/23	60-60-0001.02	A

2x4 FLAT FIRE SEPARATION WALL.
1-HOUR FIRE-RESISTIVE RATING
WITH EXPOSURE FROM BOTH SIDES
(SEE 60-60-0001.05 DETAIL 2)

ROOF SHEATHING
APPROVED FIRE-RETARDANT-TREATED
WOOD FOR A DISTANCE OF FOUR FEET

CLASS C ROOF COVERING

TRUSS

STD CEILING PANEL

FIRE SEPARATION WALL.
1-HOUR FIRE-RESISTIVE RATING
WITH EXPOSURE FROM BOTH SIDES
(SEE 60-60-0001.05 DETAIL 1)

LISTED 2 HOUR
FIRE-RESISTANT
NONMETALLIC ELECTRICAL
BOXES

MAIN RAIL

FLOOR JOIST

FULL HEIGHT CROSSMEMBER
AND OUTRIGGERS

5/8" X-TYPE GYP
EXTENDED TO BTM
OF CHASSIS X-MEMBER

FIRE SEPARATION WALL
BY OTHERS

i

FIRE SEPARATION WALLS

PROPRIETARY AND CONFIDENTIAL
These drawings and specifications are original, proprietary,
confidential materials of Fleetwood Homes, Inc.
Copyright 2019 Fleetwood Homes, Inc.

FLEETWOOD HOMES, INC.

TITLE
ATTACHED MANUFACTURED HOMES
END TO END UNITS

Calculation Numbers

By: DO

NO.

REV.

Date: 11/10/23

60-60-0001.03

A

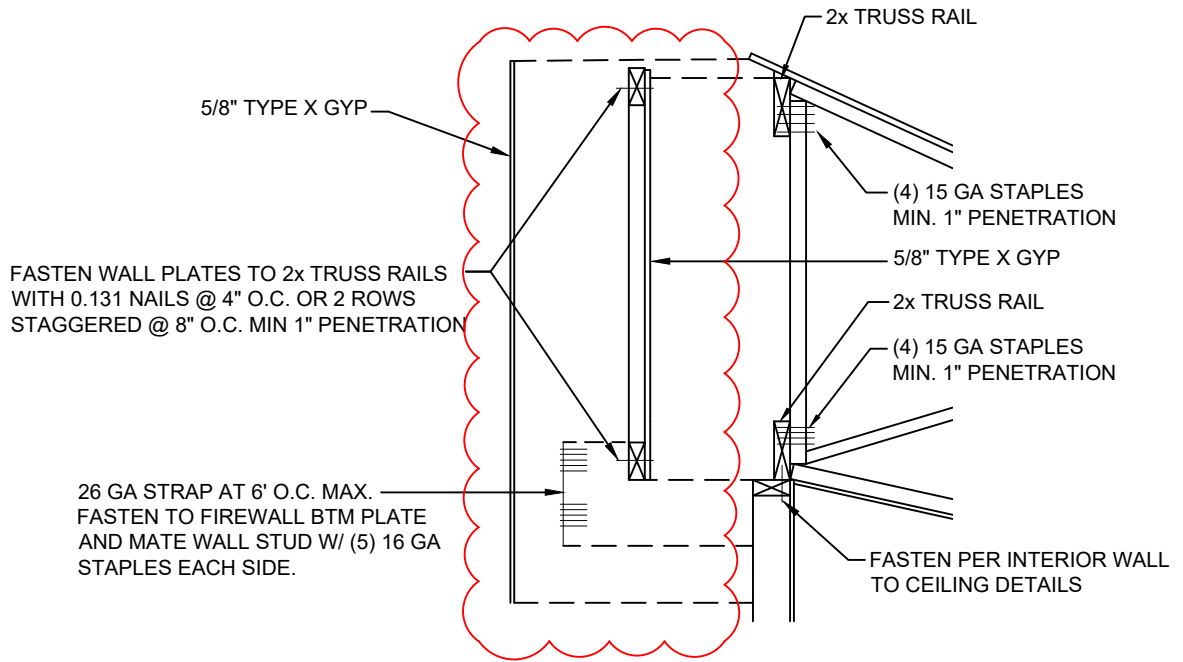

Notes:

1. 20psf RLL max.
2. 186" max. floor width
3. Wind zone 1

A

FIRE SEPARATION WALL FASTENING AND UPLIFT

PROPRIETARY AND CONFIDENTIAL
 These drawings and specifications are original, proprietary, confidential materials of Fleetwood Homes, Inc.
 Copyright 2019 Fleetwood Homes, Inc.

FLEETWOOD HOMES, INC.

TITLE
 ATTACHED MANUFACTURED HOMES
 DETAILS

Calculation Numbers

0003767

By: DO

NO.

REV.

Date: 11/10/23

60-60-0001.04

A

5/8" TYP X GYP EACH SIDE
FASTEN WITH 0.0915 x 1 7/8"
1/4" HEAD COATED NAILS OR
1 7/8" TYPE S DRYWALL SCREW
@ 7" O.C. PERIMETER AND FIELD

PANEL SEAM
(AS NEEDED)

MIN. 2x4 STUD (TYP)

24"
MIN.

24" O.C.
MAX.

Notes:

1. Gypsum Association Fire Resistance Design Manual WP 3510 or equivalent.
2. Vertical joints on opposite sides of wall shall not occur on the same stud.
3. All joints and interior angles shall have tape embedded in joint compound.
4. Framing fastening per other drawings.
5. Wall to be entire length of unit and tight fitting to each endwall.

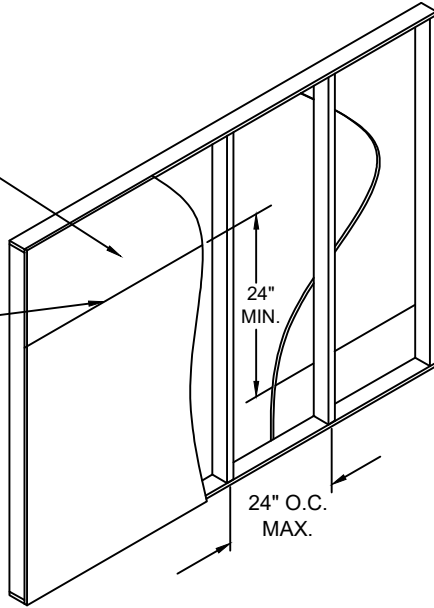

1

FIRE WALL @ MATING LINE

5/8" TYP X GYP EACH SIDE
FASTEN WITH 0.0915 x 1 7/8"
1/4" HEAD COATED NAILS OR
1 7/8" TYPE S DRYWALL SCREW
@ 7" O.C. PERIMETER AND FIELD

MIN. 2x4 TOP AND
BTM PLATES ON EDGE

MIN. 2x3 STUD
TURNED FLAT (TYP)
TOE FASTEN TO PLATES
W/ (2) 15GA STAPLES
MIN. 1" PENETRATION

24" O.C.
MAX.

Notes:

1. Gypsum Association Fire Resistance Design Manual WP 3640 or equivalent.
2. Vertical joints on opposite sides of wall shall not occur on the same stud.
3. All joints and interior angles shall have tape embedded in joint compound. Intermediate fastener heads need not be covered.
4. Wall to be entire length of unit and extend from mating line fire wall top plate to underside of roof sheathing.

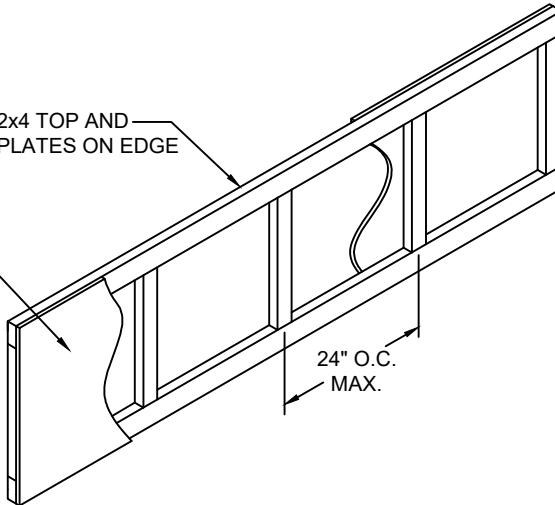

2

FIRE WALL @ ATTIC

PROPRIETARY AND CONFIDENTIAL
These drawings and specifications are original, proprietary,
confidential materials of Fleetwood Homes, Inc.
Copyright 2019 Fleetwood Homes, Inc.

FLEETWOOD HOMES, INC.

TITLE

ATTACHED MANUFACTURED
HOMES DETAILS

Calculation Numbers

By: DO

NO.

REV.

Date: 11/08/23

60-60-0001.05